

Growing with a Mission
for Sustained Usefulness
Through
Excellence in Processes
& Work-Life Perspective



“Winning Together” is our philosophy & “Business Excellence” is our passion.

A wide range of products, best in class quality, quicker deliveries, customised solutions, timely process innovations & ethical transactions have been the hallmarks of our sustained growth. We have an extensive experience of serving the customers in India and abroad. Our professional & strategic associations with many multi-nationals have given us a competitive edge in the market.

We add value to every stakeholder through a collaborative approach & continual improvement in products and processes. We practice Empowerment at work & have evolved a unique “Work Temple Culture” to facilitate speed of decisions & actions.

Certified for IMS (Integrated Management System) – We at Expert, focus on a more balanced triple-bottom line encompassing economic, social and environmental objectives into our business practices (also referred to as - people, planet, and profit).

Certifications >>

- ✓ ISO 9001 : 2008
- ✓ ISO 14001 : 2004
- ✓ OHSAS 18001 : 2007
- ✓ EIL (Engineers India Ltd.)
- ✓ NTPC
- ✓ IBR (Indian Boiler Regulatory Authority)
- ✓ Project Consultants
Mecon * Toyo * APGenco * Avant Garde

Clientele >>

- Mining Industry
- Boiler Companies
- Energy and Environment plants
- Thermal Power Stations
- Pulp and Paper Industry
- Cement Industry
- Chemical & Process Industry
- Water Treatment Industry
- Filtration System manufactures
- Paint Manufacturers
- Oil & Gas Industry
- Agriculture Equipments
- HVAC Sector
- Lube Oil System manufactures
- Valve manufacturing companies & OEM's
- Dealers and Distributors in India and abroad

Industrial Valves



Gate, Globe, Check Valves - IBR / NIBR

Complies to API-600, BS-1873, BS-1868

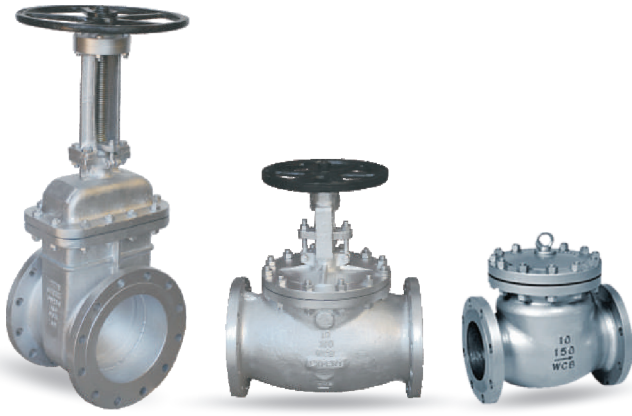

Size : 15 mm to 600 mm
Type : Gate, Globe, Check
Material : WCB, CF8, CF8M, CF3, CF3M, WC6, WC9.
Ends : Flanged
Rating : Class 150, 300, 600
Operation : Manual, Gear or Electric Actuator
Specials : Jacketed Construction, Extended Bonnet
Testing : As per API 598 / BS EN 12266

Forged Steel Valves - IBR / NIBR

Complies to API-602, BS EN ISO 15761



Size : 15 mm to 50 mm
Type : Gate, Globe, Check
Material : A105, F304, F316, F11, F22.
Ends : Screwed, Socket Weld, Butt Weld / Flanged
(Weld on)
Rating : Class 800, 1500, 2500.
Special : Extended Bonnet
Testing : As per API 598 / BS EN 12266

Bellow Seal Valves - IBR / NIBR

Complies to MSS-SP 117/BS-1873



Size : 25 mm to 250 mm
Type : Bellow Seal Globe
Material : WCB, CF8, CF8M, CF3, CF3M.
Ends : Flanged
Rating : Class 150, 300
Operation : Manual, Gear or Electric Actuator
Option : Forged Steel Valve - Screwed/Socket Weld End,
Range 15 mm to 50 mm
Testing : As per API 598

Ball Valves

Complies to BS EN ISO 17292



Size : 15 mm to 200 mm
Type : 2 way / 3 way (Full Port / Reduced Port)
Material : A105, WCB, CF8, CF8M, CF3M.
Seat : PTFE, RPTFE (CFT), PEEK, Metal, DEVLON,
NYLON
Rating : Class 150, 300, 600, 800
Ends : Screwed, Socket Weld, Butt Weld, Flanged
Operation : Lever, Gear, Pneumatic, Electric Actuator
Testing : As per API 598 / BS EN 12266

Knife Gate Valves

Complies to MSS-SP81



- Size : 50 mm to 1000 mm
- Type : Uni-Directional / Bi-Directional
- Material : CI, DI, WCB, CF8, CF8M, CF3, CF3M.
- Ends : Wafer, Lugged
- Operation : Handwheel, Chain-wheel, Gear, Lever, Pneumatic or Electric Actuator
- Specials : Extended Stem, Closed Bonnet, Deflector Cone, Soft Seated, Purge Connection
- Testing : As per MSS-SP81

Butterfly Valves

Complies to BS EN-593 / IS-13095 / API 609



- Size : 40 mm to 800 mm
- Type : Wafer type resilient seated
- Material : CI, DI, WCB, CF8, CF8M, CF3, CF3M.
- Ends : Wafer
- Rating : PN 10 / PN 16
- Operation : Lever, Gearbox, Pneumatic Electric Actuator
- Testing : As per API 598 / BS EN 12266

Wafer Check Valves

Complies to API 6D



- Size : 25 mm to 1000 mm
- Type : Eccentric Mounted Disc
- Material : CI, DI, WCB, CF8, CF8M, CF3, CF3M.
- Seat : Nitrile, EPDM, Viton, Silicon, PTFE
- Ends : Wafer
- Specials : Dashpot / Counter weight arrangement
- Testing : As per API 598

Non-Slam Check Valves - IBR / NIBR

Complies to EXPERT's Specification

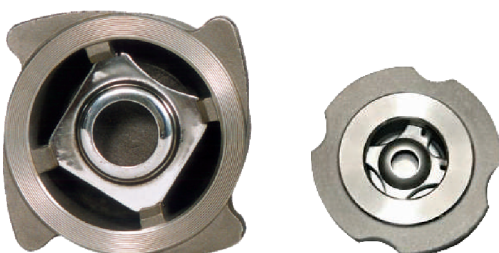

- Size : 15 mm to 150 mm
- Type : Non-Slam
- Material : CF8M.
- Seat : Metallic or Soft Seat
- Ends : Wafer
- Rating : Class 150, 300, PN-40
- Testing : As per API 598

Ushering a more purposeful tomorrow



ADVANTAGE **Expert**

- WIN-WIN Approach
- Customized Solutions
- Range of High Quality Products
- Shorter Product Development Cycles
- Professional Execution
- Flexibility & Reliability



Corporate Social Responsibility

For a business to be sustained long-term, a company needs to replace a single-financial bottom line with a more balanced triple-bottom line encompassing economic, social and environmental objectives into its business practices (also referred to as "people, planet, profit"). At Expert, the CSR approach outlines key areas of focus and guidance for its implementation which ultimately seek to achieve these three objectives. Our focus is to contribute in the areas of Education & Environment.

- * Educational Aid to our employee's children
- * School Adoption in Rural India since 2008
- * Financial support to the local orphanage
- * Voluntary Blood Donation Camp every year



- * Tree Plantation Programme
- * Green Zone Project
- * Tobacco Free Campus
- * Purification of Environment through "Agnihotra"

Think Valve  Think **EXPERT**

Expert Valve and Equipment Private Limited

Authorized Dealer

ARPAN ENGINEERING CORPORATION

606, Zee Nayak, MG Road, Vile Parle East. mumbai - 400057.

Email : aecptc@gmail.com

Contact : 022-26171812 / 13 M - 9869449603 / 9029757570

www.expertvalves.com